

# Custom Wood Homes

LOG HOMES | TIMBER HOMES | NATURAL MATERIALS | GREEN

favorite designs:  
western and  
southwest plans

20 expert decorating tips  
inside a reconstructed ranch

exterior designs  
5 great ideas

15 custom projects  
for any budget

green  
growth

building small with natural materials  
10 construction ideas for big savings  
eco-friendly building tips

# retreat on

A BLEND OF HISTORIC AND NEW ARCHITECTURE ENSURES A WORKING RANCH IN WYOMING WILL ENDURE

**W**hat was once a focus for wrangling steers has become important as a center for rest and relaxation. The historic Fayette Ranch in western Wyoming has long been a symbol of the Rocky Mountain range cattle industry. Early in the 20th century, a handsome U-shaped log home was erected in the midst of 2,000 acres, and as proof of the value of log and other durable building materials, when the ranch was purchased to serve as a vacation home a few years ago, it was still a viable structure. It just needed updating and expansion.

Ellis Nunn & Associates and Teton Heritage Builders from nearby



# the range



Jackson were called upon to develop a 21st century retreat without demolishing the existing structures, including several wrangler cabins that could become guest homes. Excited by the chal-

CONTINUED ON  
PAGE 84

**Opposite Top:** From the entry doors, it's a straight path to the new great room, but if you turn instead down this hallway, you'll find the guest wing in the historical section of the home. As in most of the house, hand-forged iron lighting fixtures imported from France (with a decidedly American West flare) are mounted overhead.

**Opposite Bottom:** One of the many highlights in the great room is the massive fireplace with the floor-level hearth. The stone bench continues all the way around the fireplace through a hallway.

**Left:** The homeowner brought in naturalists to improve the surroundings. While there had been a small stream meandering across the property, by carefully damming it downstream, they were able to create not only a lovely water feature to be enjoyed from the home, but have also ensured that the wildlife has a watering hole in dry seasons.

## Nothing Like a Little Challenge

As appealing as a big ranch in the middle of nowhere may seem, it comes with its own set of challenges just to get a home built. "Nowhere" is usually equipped with little or no basic infrastructure in place.

In the instance of the Fayette Ranch project, however, Teton Heritage Builders enjoyed better than average conditions. Unlike another project (at which it took five months just to cut a road to the site and then 12-14 months to get water and electrical connections), because of the existing structures at Fayette, there were fewer immediate



**Top:** Nowhere is the blend of old and new more beautifully crafted than in the courtyard. While the log and terra cotta roof of the historic section of the home are in the background, the foreground shows off the 18- to 20-inch hand-hewn Douglas fir logs in the new area. Handcrafted doors were utilized inside and out, and mountain rock adds attractive contrast as well as a measure of protection for the logs following significant snowfalls or from splashing during occasional summer thunderstorms.

**Above:** The custom kitchen has alder cabinets and lots of work room, as well as a breakfast bar to encourage the friendly feel of the home. The recessed cooktop surrounded by stone is just one of many engaging features in the kitchen.



**Left:** Unlike many breakfast nooks that lean toward the cozy, this one continues the sense of spacious living. Just as in much of the rest of the home, the nook has reclaimed hickory flooring, a soaring, vaulted ceiling, and a magnificent view.

and a half. Others usually worked long four-day weeks and then returned to their homes for the weekend. Day laborers from a nearby town occasionally drove in, but as Teton Heritage's Peter Lee notes, "This is a part of the country where people are used to healthy commutes."

While it would have admittedly been easier to simply raze the old structure and begin over at the footprint, when it became clear that the homeowners were intent on retaining the original structure, planning went forward smoothly. And there were no real surprises. As Lee noted, "I once remodeled the oldest building on Georgetown University's campus, and you would tear down one wall and find another behind it. We didn't have anything like that occur on this project and that made it go very well as a result."

The existing support from the septic system to the electrical system to the HVAC had to be replaced as the home went from 3,000 square feet to more than 11,000. The fact that gutting the interior and rebuilding went so smoothly is a tribute to the architectural team, according to Lee. "I can't say enough about how well prepared they had us."

JOYCE STANDRIDGE

needs. Teton Heritage had to rebuild a couple of bridges across streams because they did not have enough tonnage allowance to hold the concrete trucks that would be going across. But at least there were basic installations.

And some aspects of the project were easy enough. For example, unlike some areas of the West where planning approval can take literally months and require potential

homeowners and their architects to redraft plans seemingly *ad infinitum*, for this project the team satisfied the county by providing a map of the septic system and paying a \$75 fee.

As the project got underway, the crew — which ranged from six to eight carpenters and laborers most of the time — literally moved on-site into the wranglers' cabins. The superintendent and his wife relocated to the site full-time for a year

# retreat on the range

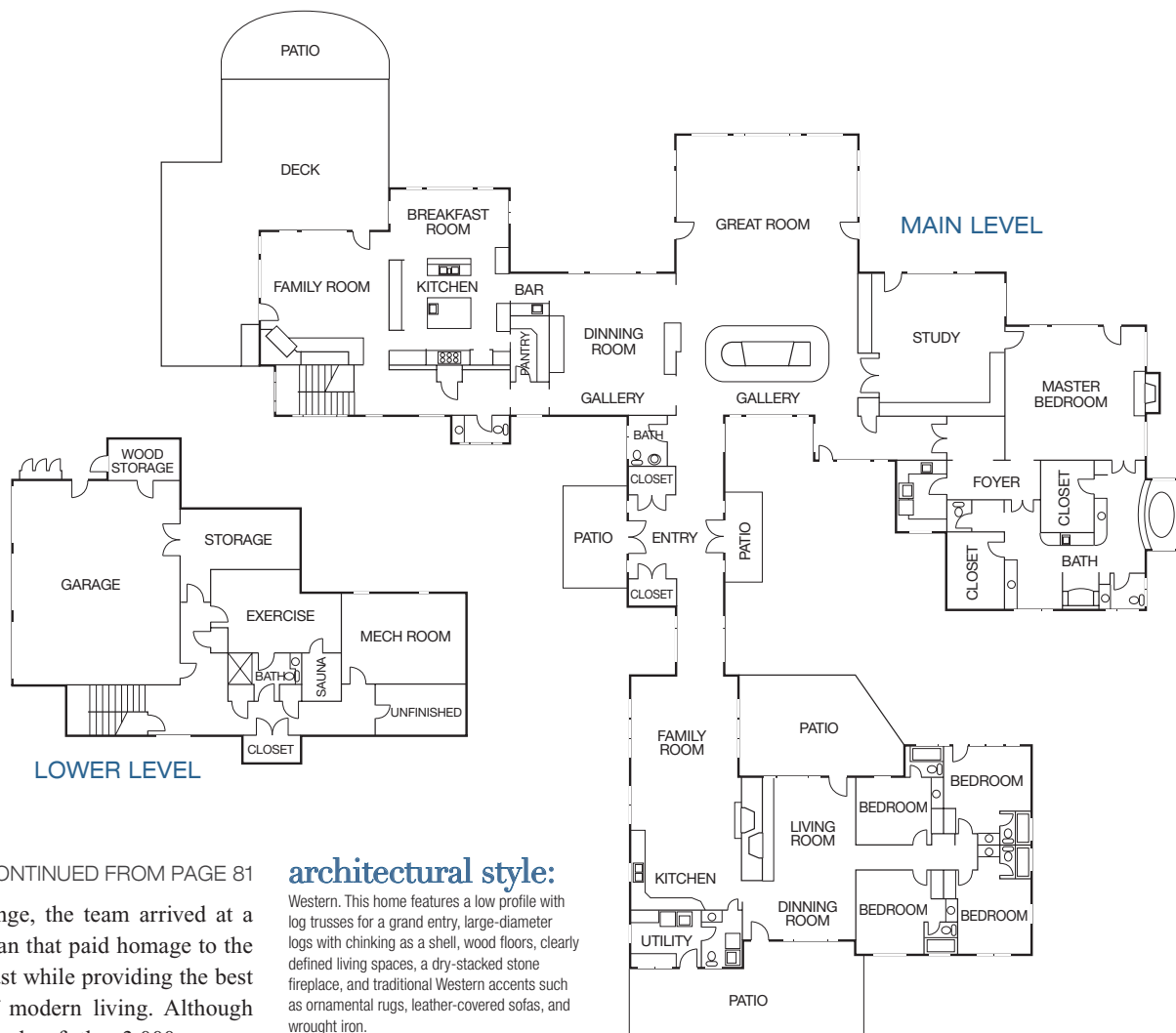

CONTINUED FROM PAGE 81  
 lenge, the team arrived at a plan that paid homage to the past while providing the best of modern living. Although much of the 3,000-square-foot existing interior was gutted and redesigned to provide a self-sustaining guest wing, the team retained the lodgepole pine exterior walls and the terra cotta tile roof. For the new 8,000-square-foot L-shaped main living area, Douglas fir was chosen for the logs and cedar-shake

## architectural style:

Western. This home features a low profile with log trusses for a grand entry, large-diameter logs with chinking as a shell, wood floors, clearly defined living spaces, a dry-stacked stone fireplace, and traditional Western accents such as ornamental rugs, leather-covered sofas, and wrought iron.

**Right:** The great room was designed to afford a three-sided view of the outdoors. Large argon-filled windows ensure both comfort and pleasure. The 50-foot-by-30-foot room allows space for several conversational groupings, an especially appreciated feature when family, friends, and business associates accompany the homeowners to the retreat.





**Left:** A wide deck off the dining area — one of several substantial outdoor living areas surrounding the home — provides a satisfying place to indulge in meals, card and board games, and social occasions. After hunting excursions, canoeing, leisurely lakeside strolls, or drives around the five-square-mile ranch, this deck is a logical gathering spot.

**Below:** Throughout the home are instances of horseshoe-shaped beams that were crafted by wetting log splices, shaping them, drying them in kilns, and repeating the process multiple times until the final shape was achieved. The pieces were then laminated to create the arch. The result honors the Western history of the area, and it also ensures that the breathtaking views will not be compromised. The logs and trusses were crafted on-site by the builder.



# retreat on the range



shingles on the roof. Even though different materials were used, they were selected to integrate with the existing structure, and have done it so well that it's impossible to tell this wasn't planned exactly this way 75 years ago. *CWH*



**TETON  
HERITAGE  
BUILDERS**

**Wyoming**  
P.O. Box 4819  
160 West Deloney Ave.  
Jackson, Wyoming 83001  
Phone: 307.733.8771

**Montana**  
80127 Gallatin Road  
Suite B  
Bozeman, Montana 59718  
Phone: 406.522.0808

## home bio:

**SQUARE FOOTAGE:** Total 12,650. Existing Ranch House 2,850; new addition 7,580 upstairs, 700 downstairs, 1,520 garage  
**BEDROOMS:** Existing 3 Bedrooms; New 1 bedroom, 1 Master  
**BATHROOMS:** Existing 2.5; new 1.75, 1 master, 2 powder baths  
**ARCHITECT:** Ellis Nunn & Associates, Jackson, WY  
**PROJECT ARCHITECT:** Danny Béasse  
**HOME PRODUCER, BUILDER:** Teton Heritage Builders, Jackson WY  
**INTERIOR/DESIGNER:** Owner  
**CHINKING:** Sashco Log Jam  
**WINDOWS:** Sierra Pacific  
**DOORS:** Quality Woodworks, St. Anthony, ID  
**FIREPLACES:** Peterson & Associates (stone); Jordan Metal Works (screens)  
**LIGHTING FIXTURES:** Laurie Interiors, Jackson WY  
**CABINETRY:** Callaghan Cabinets, Pinedale, WY

**Top:** *In the master suite, consideration for comfort was a big part of the plan. Flanking the bed are doors to the master bath so both spouses have easy access. The wood-burning fireplace adds warmth and ambience to a room as inviting as any in the home.*

**Left:** *The family room's entertainment center, constructed from alder, is flanked by a mountain-rock fireplace and a huge window overlooking the lake. The French door opens to another large deck with an extraordinary view of the mountain vista.*